

MARMILINE ENGINEERED STONE

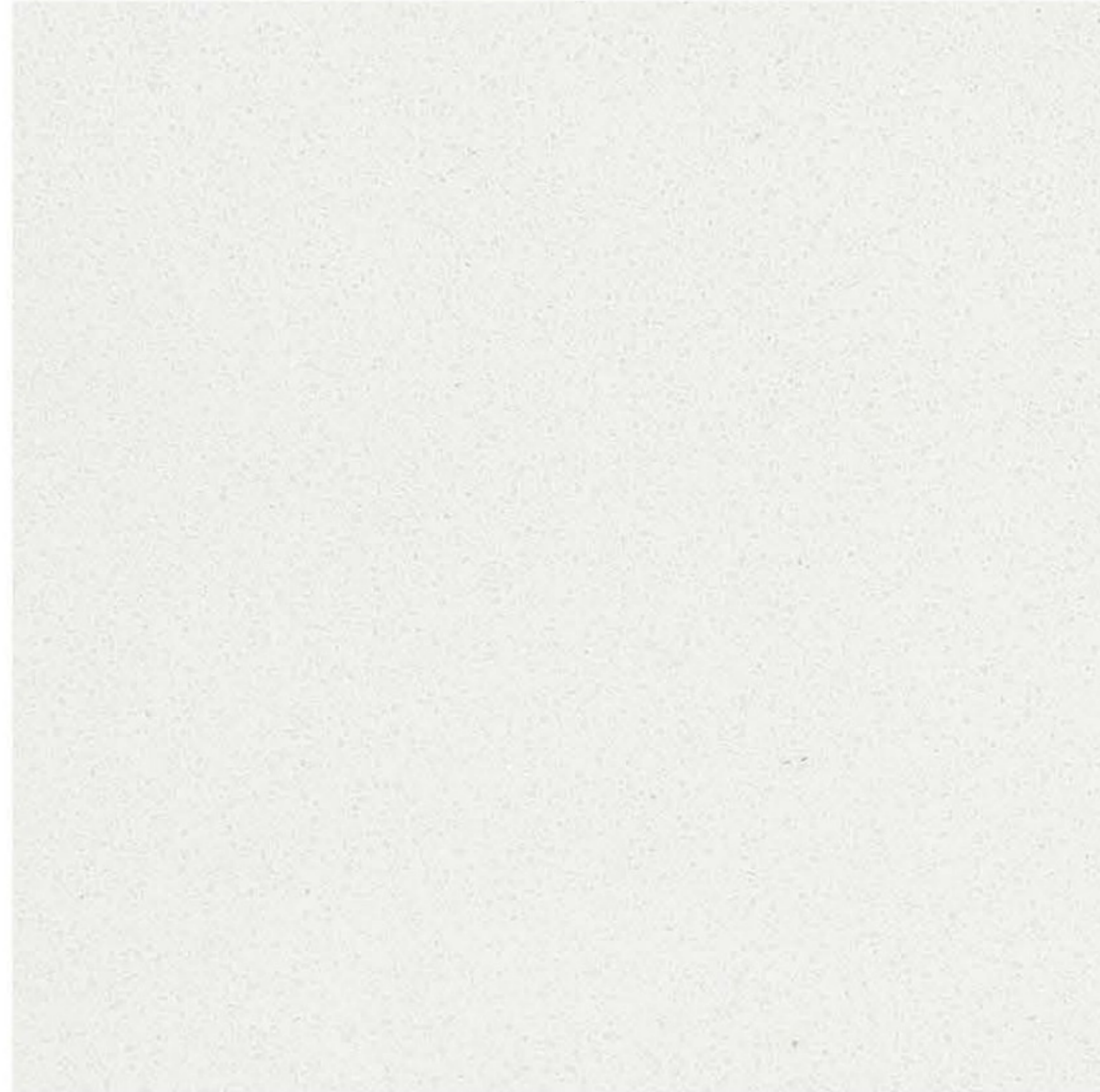

MARMILINE ENGINEERED STONE



MARMILINE SNOW POLISHED ENGINEERED STONE

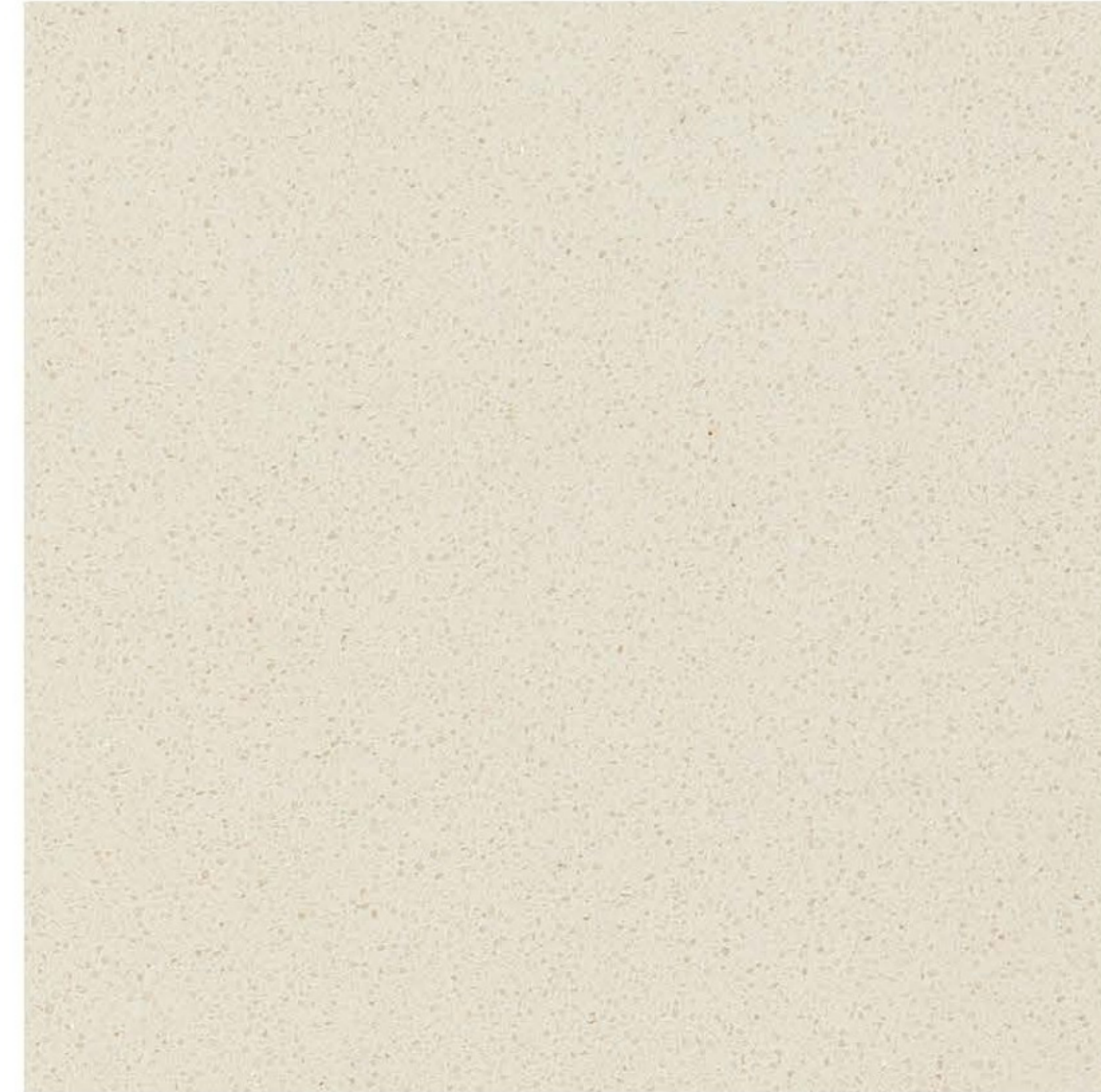

MARMILINE IVORY POLISHED ENGINEERED STONE

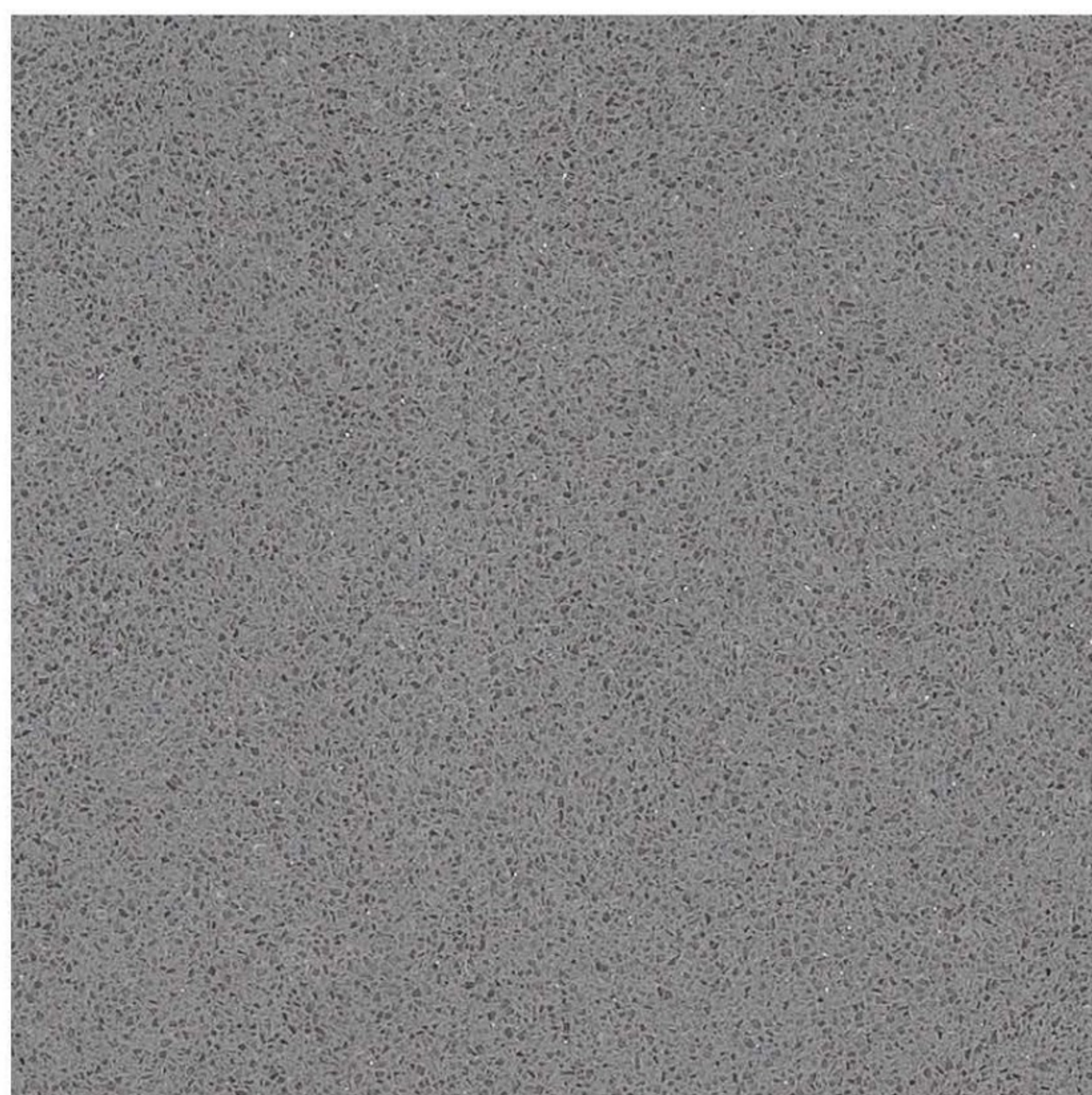

MARMILINE SHADOW POLISHED ENGINEERED STONE



MARMILINE PEARL POLISHED ENGINEERED STONE



MARMILINE ASH POLISHED ENGINEERED STONE

MARMILINE ENGINEERED STONE

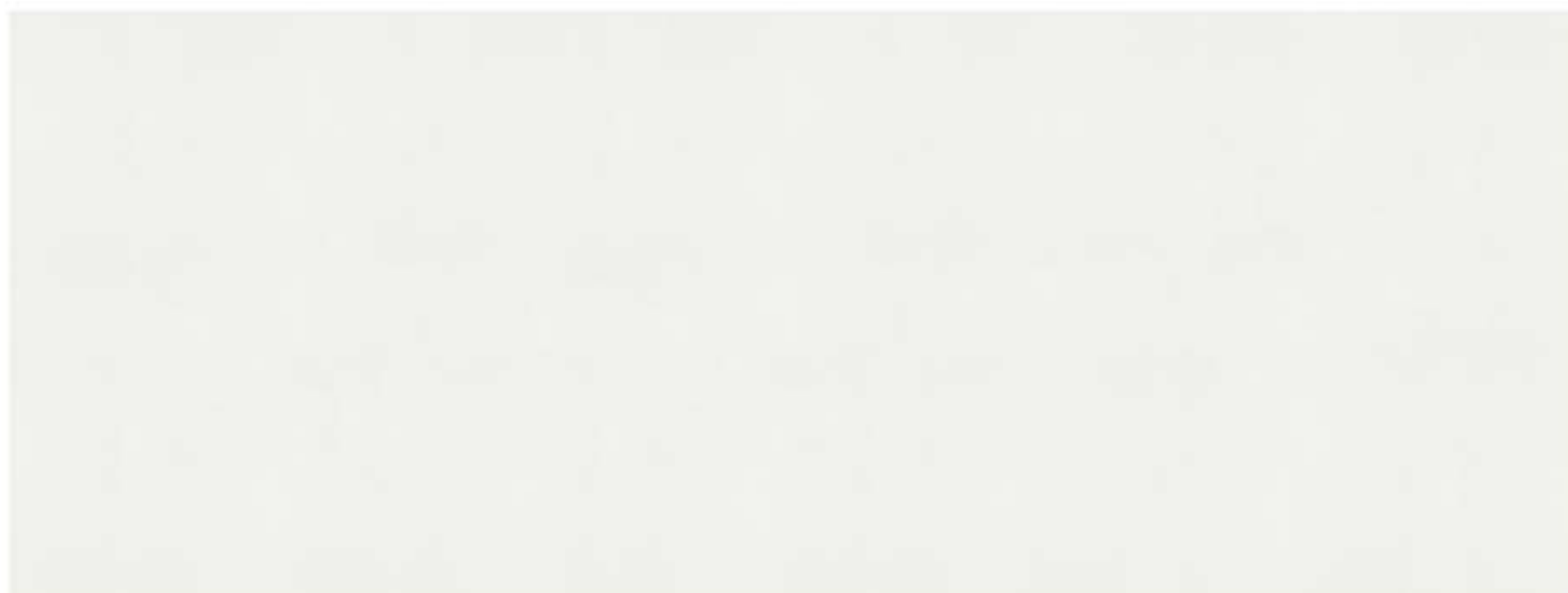

18" x 47.2" MARMILINE SNOW POLISHED ENGINEERED STONE BENCH
B1847SN



6" x 76" MARMILINE SNOW POLISHED ENGINEERED STONE SILL
W676SN



6" x 94.5" MARMILINE SNOW POLISHED ENGINEERED STONE SILL
WS694SN



4" x 36" MARMILINE SNOW POLISHED ENGINEERED STONE THRESHOLD
TH436SN



2" x 36" MARMILINE SNOW POLISHED ENGINEERED STONE THRESHOLD
TH236SN



8.9" MARMILINE SNOW POLISHED
ENGINEERED STONE ROUND
CORNER SHELF
CS9SN

MARMILINE ENGINEERED STONE



18" x 47.2" MARMILINE IVORY POLISHED ENGINEERED STONE BENCH
B1847I



6" x 76" MARMILINE IVORY POLISHED ENGINEERED STONE SILL
WS676I



6" x 94.5" MARMILINE IVORY POLISHED ENGINEERED STONE SILL
WS694I



4" x 36" MARMILINE IVORY POLISHED ENGINEERED STONE THRESHOLD
TH436I



2" x 36" MARMILINE IVORY POLISHED ENGINEERED STONE THRESHOLD
TH236I



8.9" MARMILINE IVORY POLISHED
ENGINEERED STONE ROUND
CORNER SHELF
CS9I

MARMILINE ENGINEERED STONE



18" x 47.2" MARMILINE SHADOW POLISHED ENGINEERED STONE BENCH
B1847SH



6" x 76" MARMILINE SHADOW POLISHED ENGINEERED STONE SILL
WS676SH

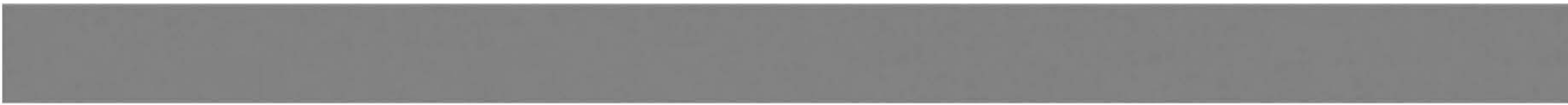

6" x 94.5" MARMILINE SHADOW POLISHED ENGINEERED STONE SILL
WS694SH



4" x 36" MARMILINE SHADOW POLISHED ENGINEERED STONE THRESHOLD
TH436SH



2" x 36" MARMILINE SHADOW POLISHED ENGINEERED STONE THRESHOLD
TH236SH



8.9" MARMILINE SHADOW POLISHED
ENGINEERED STONE ROUND
CORNER SHELF
CS9SH

MARMILINE ENGINEERED STONE

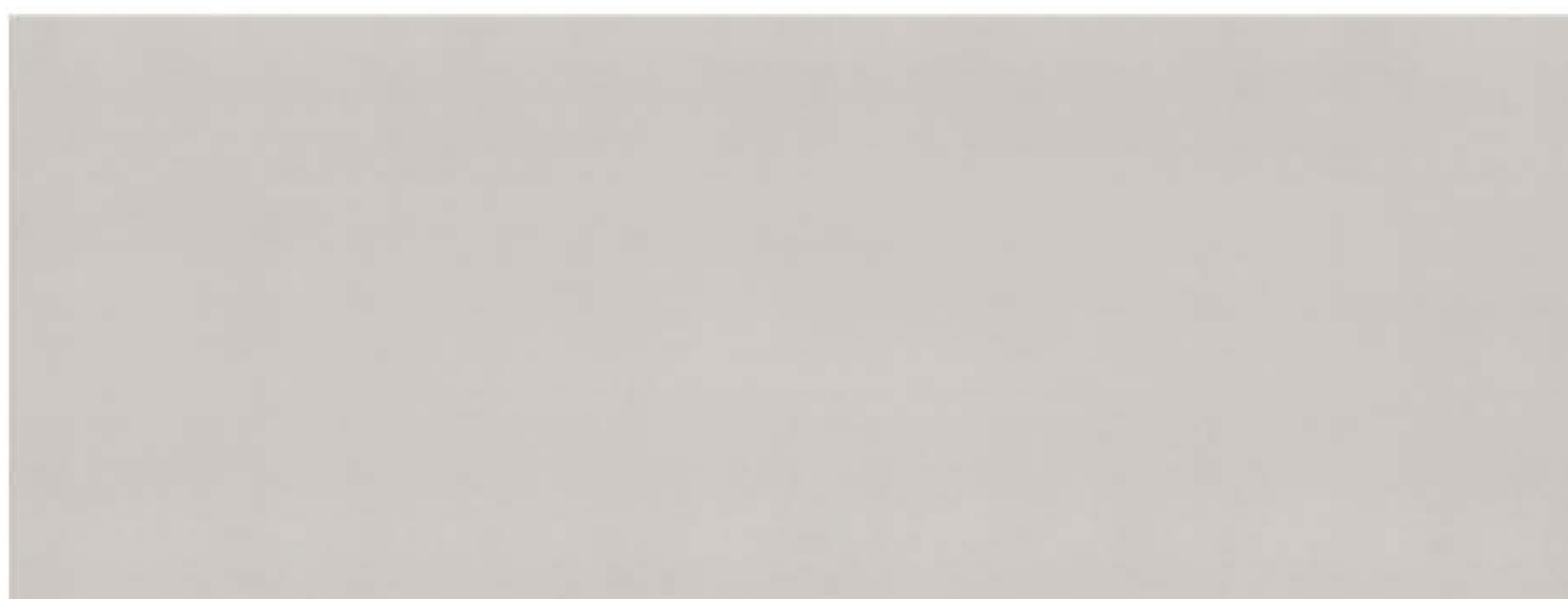

18" x 47.2" MARMILINE PEARL POLISHED ENGINEERED STONE BENCH
B1847P



6" x 76" MARMILINE PEARL POLISHED ENGINEERED STONE SILL
WS676P



6" x 94.5" MARMILINE PEARL POLISHED ENGINEERED STONE SILL
WS694P



4" x 36" MARMILINE PEARL POLISHED ENGINEERED STONE THRESHOLD
TH436P



2" x 36" MARMILINE PEARL POLISHED ENGINEERED STONE THRESHOLD
TH236P



8.9" MARMILINE PEARL POLISHED
ENGINEERED STONE ROUND
CORNER SHELF
CS9P

MARMILINE ENGINEERED STONE



18" x 47.2" MARMILINE ASH POLISHED ENGINEERED STONE BENCH
B1847A



6" x 76" MARMILINE ASH POLISHED ENGINEERED STONE SILL
WS676A



6" x 94.5" MARMILINE ASH POLISHED ENGINEERED STONE SILL
WS694A



4" x 36" MARMILINE ASH POLISHED ENGINEERED STONE THRESHOLD
TH436A



2" x 36" MARMILINE ASH POLISHED ENGINEERED STONE THRESHOLD
TH236A



8.9" MARMILINE ASH POLISHED
ENGINEERED STONE ROUND
CORNER SHELF
CS9A

MARMILINE ENGINEERED STONE



ENGINEERED STONE SILL & BENCH



ENGINEERED STONE SILL & BENCH

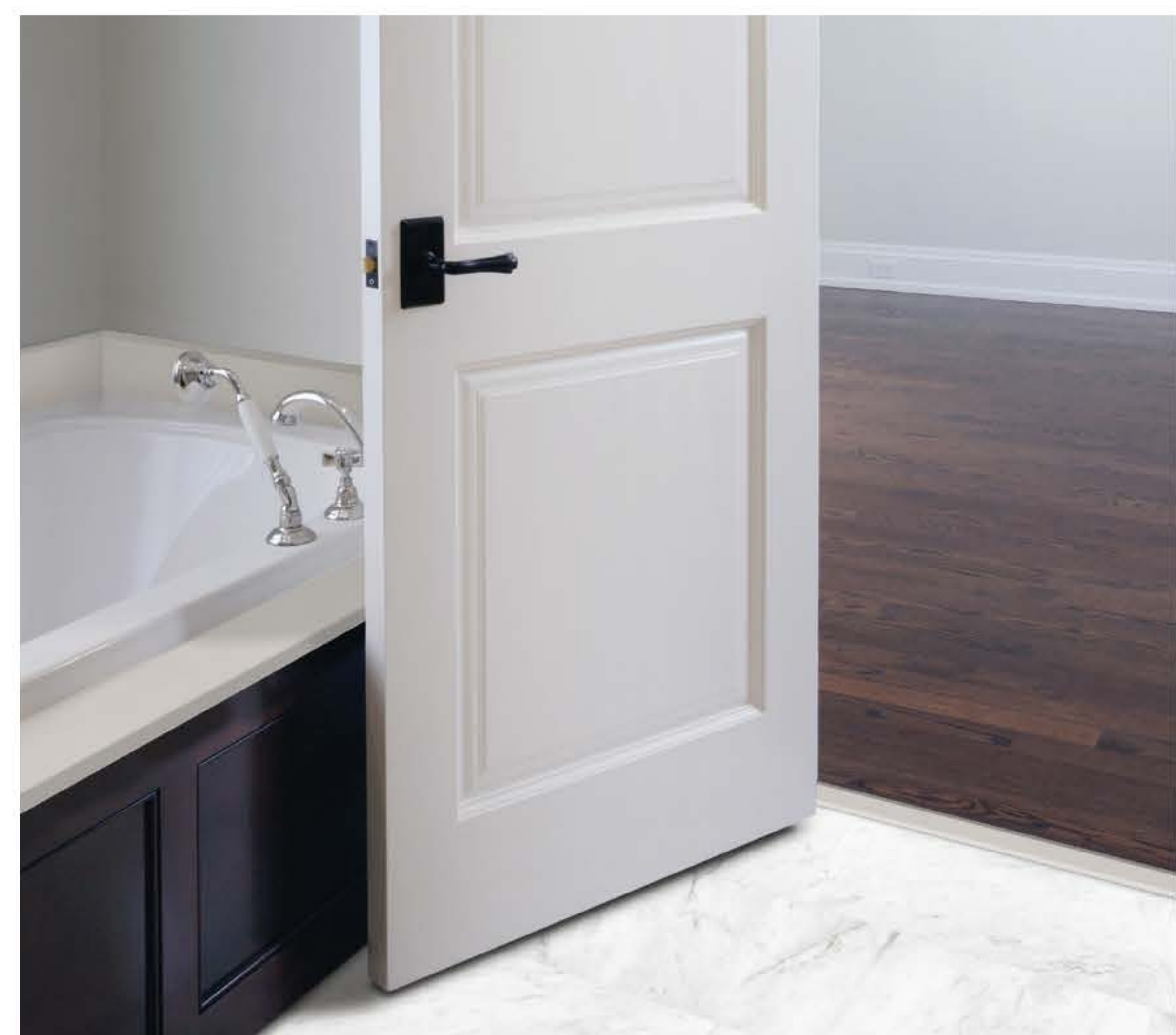

ENGINEERED STONE THRESHOLD & SILL

- Engineered stone is durable, easy to clean and maintain
- Ideal option to trim showers, window sills, niches and tub surrounds
- Easy to cut, bevel and polish on site as needed
- Optional trim pieces include corner shelves, benches and door thresholds

- Large format, seamless consistent appearance
- Creates a clean custom fabricated look
- Minimal grout means less area for stains and maintenance
- Creates a flat, even surface to easily mount fixtures
- Less time to install than multi-piece alternatives

MARMILINE ENGINEERED STONE SILL

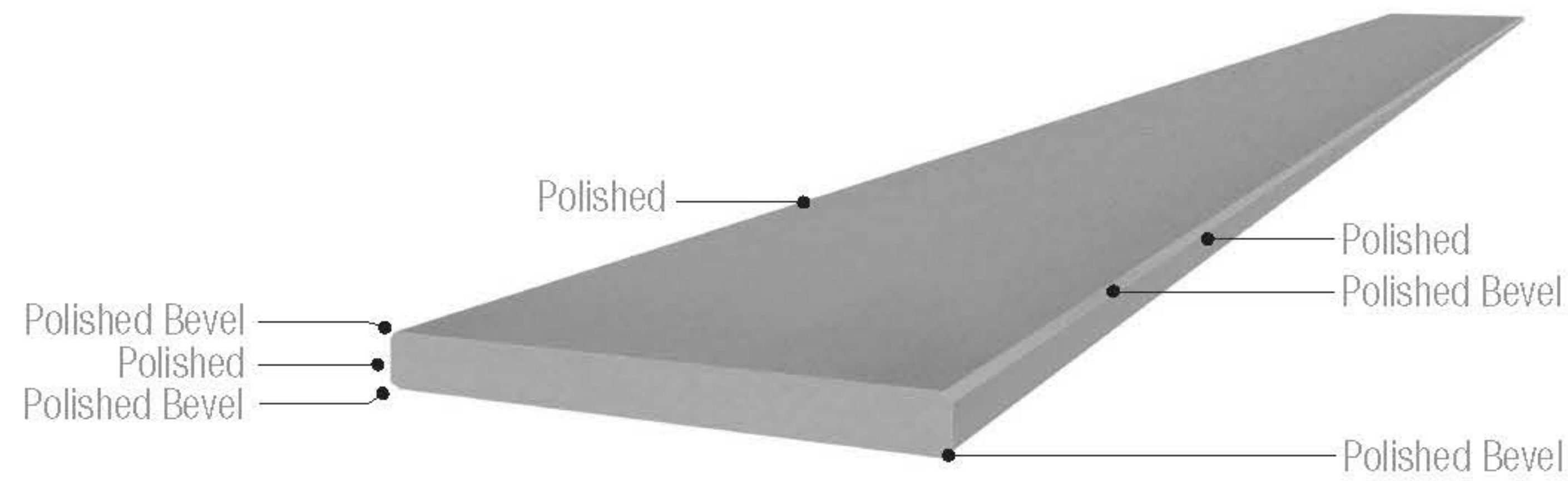

Sealing:

All engineered stone should be sealed using a high-quality impregnating sealer prior to installation following the manufacturer's instructions. It is strongly recommended to seal again after installation to reseal any areas that may have been affected during the installation process.

General Care & Maintenance:

- Wipe up any spills immediately and clean using a damp cloth or sponge.
- Daily cleaning: Use a soft cloth with warm water and small amount of mild, neutral detergent.
- Do not use abrasives, steel wool, or any products that may scratch the surface.
- For light stains, gently apply rubbing alcohol to the stain. Rinse and wipe dry.
- For heavier stains, soak a cloth with a 50/50 mix of bleach and water. Leave on top of the stain for 10 minutes, but no longer than 30 minutes. Rinse and wipe dry.
- Note: Engineered stone products are not recommended for steam showers.

How to install:

1. Cut the engineered stone (face side up) to the required length with a wet saw with a continuous diamond blade.
2. Clean surface thoroughly prior to adhering the threshold to the shower curb.
3. Seal the engineered stone using a high quality impregnating sealer as noted above.
4. Adhere threshold to curb using a modified polymer thinset.
5. Build up outside edge of curb with thinset to create a 1/4" slope towards the inside of the shower for proper drainage when using as a shower sill.
6. Caulk at the walls and under the sill using silicone caulking to prevent water leaks.
7. Refer to the TCNA (Tile Council of North America) Handbook. For further information regarding installation requirements at <http://www.tcnatile.com/>

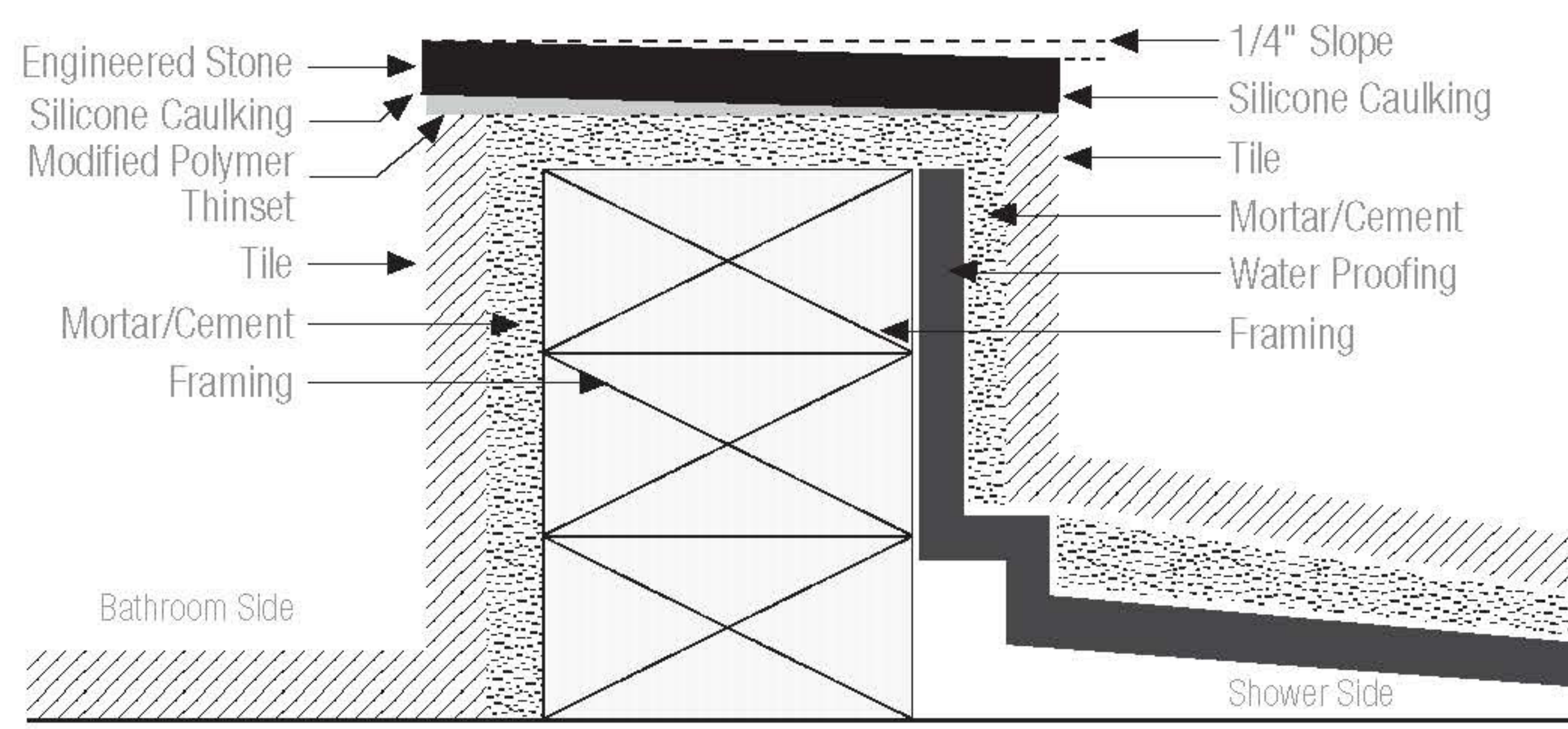
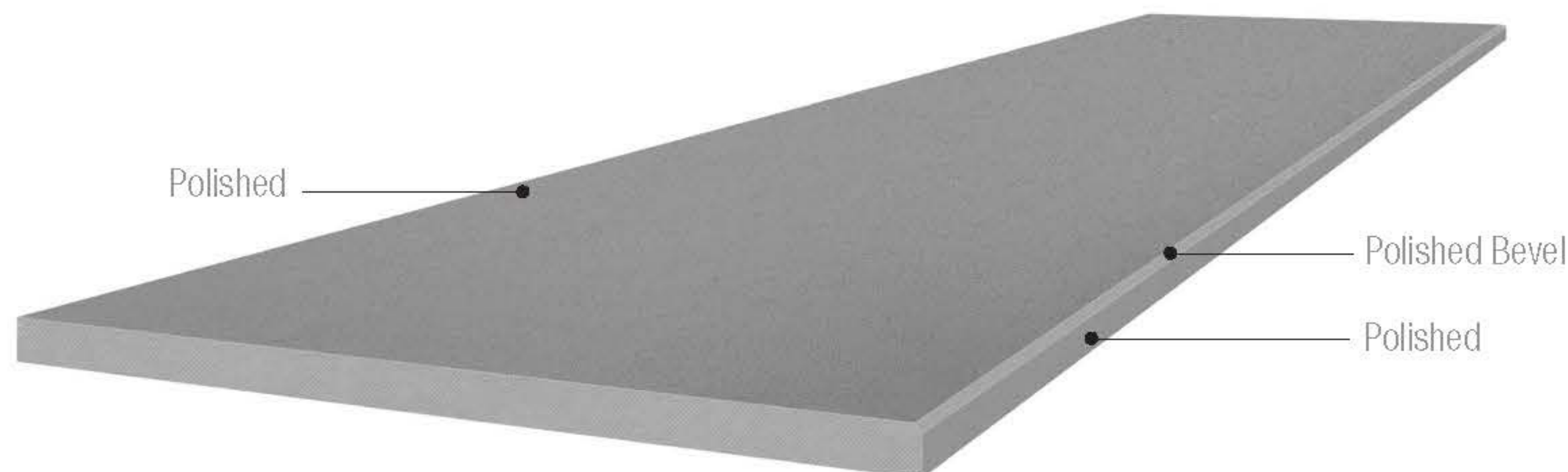

Fig.1 Installation Diagram

MARMILINE ENGINEERED STONE BENCH



Sealing:

All engineered stone should be sealed using a high-quality impregnating sealer prior to installation following the manufacturer's instructions. It is strongly recommended to seal again after installation to reseal any areas that may have been affected during the installation process.

General Care & Maintenance:

- Wipe up any spills immediately and clean using a damp cloth or sponge.
- Daily cleaning: Use a soft cloth with warm water and small amount of mild detergent.
- Do not use abrasives, steel wool, or any products that may scratch the surface.
- For light stains, gently apply rubbing alcohol to the stain. Rinse and wipe dry.
- For heavier stains, soak a cloth with a 50/50 mix of bleach and water. Leave on top of the stain for 10 minutes, but no longer than 30 minutes. Rinse and wipe dry.
- Note: Engineered stone products are not recommended for steam showers.

How to install:

1. Cut the engineered stone (face side up) to the required length with a wet saw with a continuous diamond blade.
2. There are several choices for the framing on which the engineered stone will sit on. After-market, pre-fabricated benches can be used, or a structure can be created with the use of a substrate and a waterproof membrane such as a Kerdi-board.
NOTE: A free floating bench design cannot be used with this engineered stone
3. Ensure that the top of the bench is sloped with a 1/4" angle toward the front of the bench to allow proper drainage.
4. Seal the engineered stone using a high quality impregnating sealer as noted above.
5. Install the engineered stone benchtop using a premium, unmodified thinset.
6. Important notes: Waterproofing on the walls must be continuous from the wall, over the top of the bench, and down over the face. The top of the bench must be sloped towards the drain. If using a wooden structure, waterproofing over it is required and must be attached to the floor and wall membranes.
7. Refer to the TCNA (Tile Council of North America) Handbook. For further information regarding installation requirements at <http://www.tcnatile.com/>

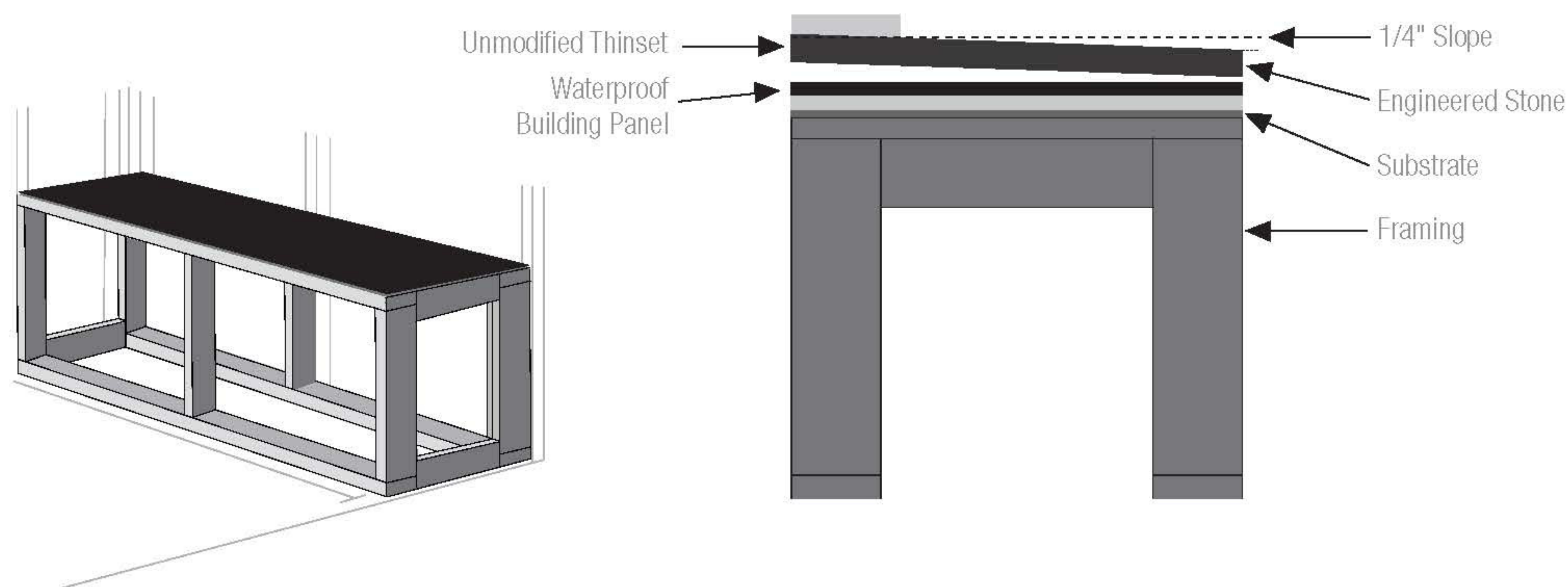
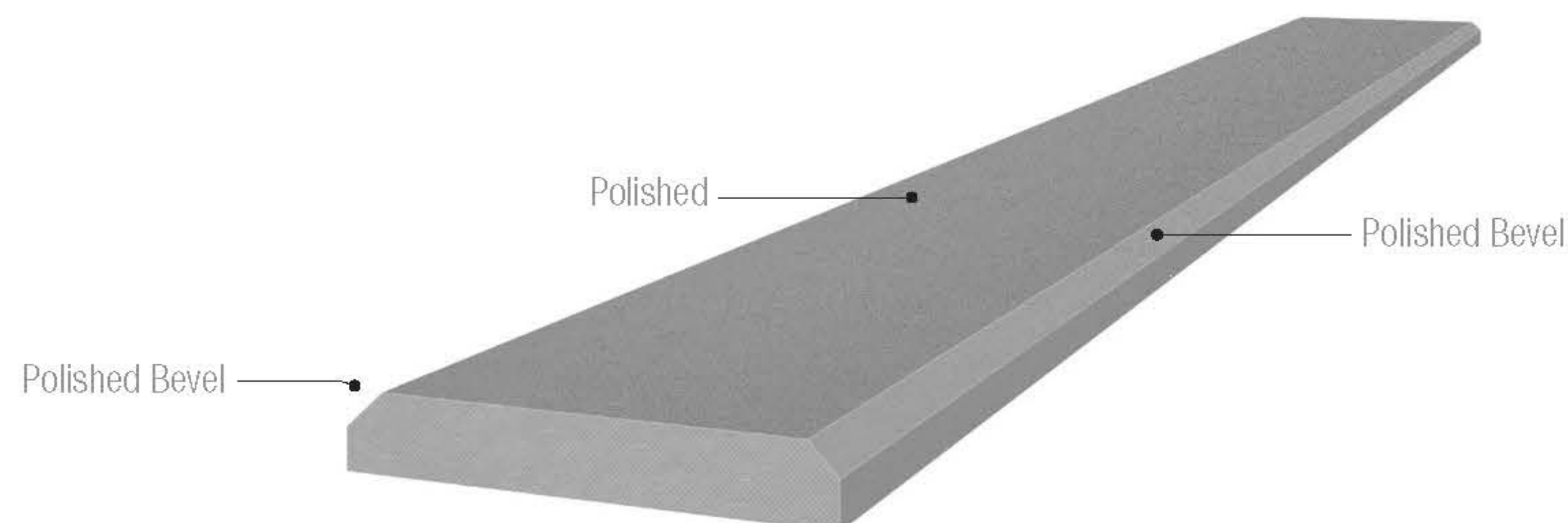

Fig.1 Installation Diagram

MARMILINE ENGINEERED STONE THRESHOLD



Sealing:

All engineered stone must be sealed using a high-quality impregnating sealer prior to installation following the manufacturer's instructions. It is strongly recommended to seal again after installation to reseal any areas that may have been affected during the installation process.

General Care & Maintenance:

- Wipe up any spills immediately and clean the area using a damp cloth or sponge.
- Daily cleaning: Use a soft cloth with warm water and small amount of mild detergent.
- Do not use abrasives, steel wool, or any products that may scratch the surface.
- For light stains, gently apply rubbing alcohol to the stain. Rinse and wipe dry.
- For heavier stains, soak a cloth with a 50/50 mix of bleach and water. Leave on top of the stain for 10 minutes, but no longer than 30 minutes. Rinse and wipe dry.
- Note: Engineered stone products are not recommended for steam showers.

How to install:

1. Clean the area of installation by sweeping or vacuuming thoroughly, ensuring that no dirt or debris is in the area.
2. Cut the engineered stone (face side up) to the required length with a wet saw with a continuous diamond blade.
3. Clean surface thoroughly prior to adhering the threshold to the shower curb.
4. Seal the engineered stone using a high quality impregnating sealer as noted above.
5. Spread a thin layer of thinset directly onto area of installation, using a ¼" inch notched trowel to spread evenly.
6. Adhere threshold to installation area onto thinset, ensuring that it is lined up correctly before pushing firmly to secure.
7. Wait for 72 hours to allow the thinset to cure and bond to the engineered stone.
 - For heavier stains, soak a cloth with a 50/50 mix of bleach and water. Leave on top of the stain for 10 minutes, but no longer than 30 minutes. Rinse and wipe dry.
 - Note: Engineered stone products are not recommended for steam showers.
8. Refer to the TCNA (Tile Council of North America) Handbook. For further information regarding installation requirements at <http://www.tcnatile.com/>

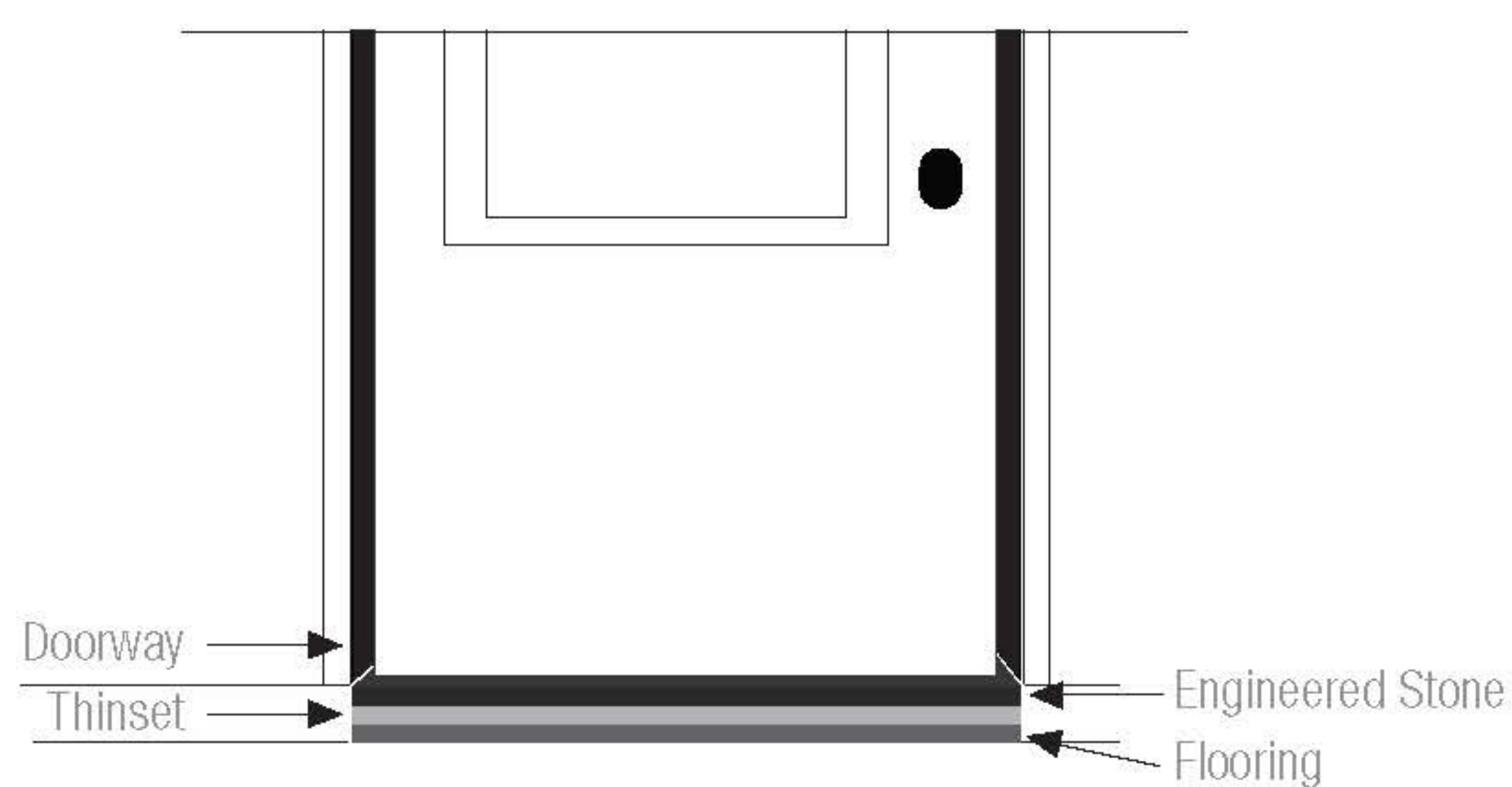
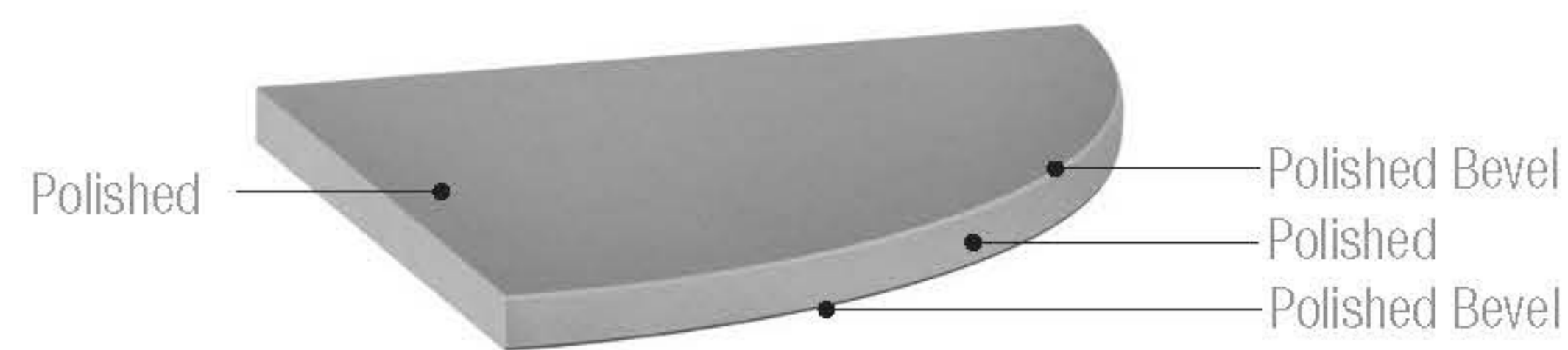

Fig.1 Installation Diagram

MARMILINE ENGINEERED STONE ROUND CORNER SHELF



Sealing:

All engineered stone must be sealed using a high-quality impregnating sealer prior to installation to minimize staining following the manufacturer's instructions. It is strongly recommended to seal the engineered stone again after installation to reseal any areas that may have been affected during the installation process.

General Care & Maintenance:

- Wipe up any spills on the tile immediately and clean the area using a damp cloth or sponge.
- Daily cleaning: Use a soft cloth with warm water and small amount of mild, neutral detergent (non-abrasive and does not contain bleach).
- Do not use abrasives, steel wool, or any products that may scratch the surface.
- For light stains, gently apply rubbing alcohol to the stain. Rinse and wipe dry.
- For heavier stains, soak a cloth with a 50/50 mix of bleach and water. Leave on top of the stain for 10 minutes, but no longer than 30 minutes. Rinse and wipe dry.
- Note: Engineered stone products are not recommended for steam showers.

How to install:

NOTE: Installation of corner shower shelf should be done at time of tiling of bathtub wall tiles to ensure easy and correct installation.

1. Clean the installation area with a neutral cleaner and lint free cloth.
2. The height at which the corner shelf should be installed should be the ideal reaching height for the people using the shower. Cut the tile to allow the width of the corner shelf to fit.
3. Apply thinset to the back of the shelf, pressing the shelf firmly into the notch while applying even pressure. Use wedge spacers to fit the shelf flush to the upper tile border, allowing the thinset 48-72 hours to cure and bond.
4. Apply silicone caulk to the top edges of the shelf to seal, using a water finger to smoothen out any excess caulk. Use a damp sponge to clean any excess caulk, using a knife to remove any extra adhesive on the top and bottom of the shelf.
5. Refer to the TCNA (Tile Council of North America) Handbook. For further information regarding installation requirements at <http://www.tcnatile.com/>

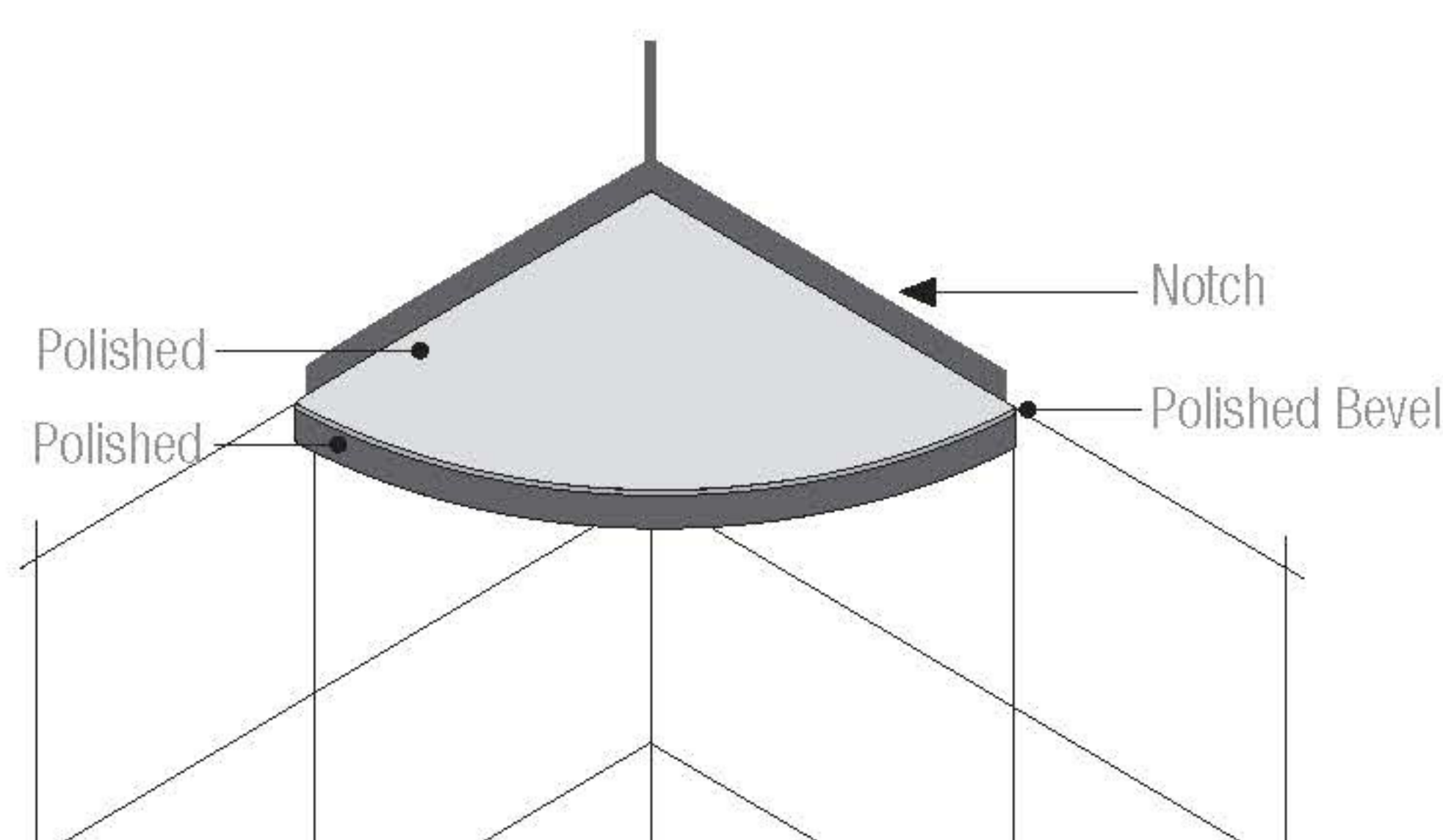

Fig.1 Installation Diagram

MARMILINE ENGINEERED STONE

PACKAGING INFORMATION

DESCRIPTION	ITEM CODE					PCS/BOX	LBS/PC	LBS/BOX	PCS/SKID
	SNOW	IVORY	SHADOW	PEARL	ASH				
18" x 47.2" MARMILINE POLISHED ENGINEERED STONE BENCH	36-011	36-012	36-015	36-014	36-013	n/a	50.71	n/a	30
6" x 76" MARMILINE POLISHED ENGINEERED STONE SILL	36-001	36-002	36-005	36-004	36-003	n/a	26.90	n/a	60
6" x 94.5" MARMILINE POLISHED ENGINEERED STONE SILL	36-006	36-007	36-010	36-009	36-008	n/a	33.51	n/a	60
4" x 36" MARMILINE POLISHED ENGINEERED STONE THRESHOLD	36-021	36-022	36-025	36-024	36-023	5	8.38	41.89	240
2" x 36" MARMILINE POLISHED ENGINEERED STONE THRESHOLD	36-016	36-017	36-020	36-019	36-018	10	4.19	41.89	480
8.9" MARMILINE POLISHED ENGINEERED STONE CORNER SHELF	36-026	36-027	36-030	36-029	36-028	10	3.15	31.52	400

GENERAL SPECIFICATIONS

DESCRIPTION	METHOD	UNIT	CORNER SHELF	THRESHOLD	THRESHOLD	SILL	SILL	BENCH
ACTUAL SIZE		mm	225 x 225 mm	51 x 914 mm	102 - 914 mm	152 x 1930 mm	152 x 2400 mm	457 x 1198 mm
		in	8.9" x 8.9"	2" x 36"	4" x 36"	6" x 76"	6" x 94"	18" x 47.2"
THICKNESS		mm - in	15 mm - 5/8"	15 mm - 5/8"	15 mm - 5/8"	15 mm - 5/8"	15 mm - 5/8"	15 mm - 5/8"
ABSORPTION BY WEIGHT	ASTM C97	(%)	0.10	0.10	0.10	0.10	0.10	0.10
DENSITY	ASTM C97	(lbs./ft ³)	150	150	150	150	150	150
COMPRESSIVE								
STRENGTH (DRY)	ASTM C170	(psi)	18500	18500	18500	18500	18500	18500
COMPRESSIVE								
STRENGTH (WET)	ASTM C170	(psi)	21000	21000	21000	21000	21000	21000
MODULUS OF RUPTURE (DRY)	ASTM C99	(psi)	4500	4500	4500	4500	4500	4500
MODULUS OF RUPTURE (WET)	ASTM C99	(psi)	4500	4500	4500	4500	4500	4500
ABRASION RESISTANCE	ASTM C241		Min. Ha 25	Min. Ha 25	Min. Ha 25	Min. Ha 25	Min. Ha 25	Min. Ha 25
SCRATCH HARDNESS	ASTM C241	(Mohs)	7	7	7	7	7	7
FLEXURAL STRENGTH	ASTM C880	(psi)	1569 (10.82 Mpa)	1569 (10.82 Mpa)	1569 (10.82 Mpa)	1569 (10.82 Mpa)	1569 (10.82 Mpa)	1569 (10.82 Mpa)
DCOF (WET)	ANSI B101.3		< 042	< 042	< 042	< 042	< 042	< 042
BOND STRENGTH	ASTM C482 - 02 (2014)	(psi)	Pass (>= 50 psi)	Pass (>= 50 psi)	Pass (>= 50 psi)	Pass (>= 50 psi)	Pass (>= 50 psi)	Pass (>= 50 psi)
SHADE VARIATION			V1	V1	V1	V1	V1	V1

* While the information has been presented with all due care, Anatolia Tile and Stone Inc. does not warrant the information is free from errors or omission. Actual colors may vary depending on product.